

new art laboratories



Reactif

Reactif Urine Analysis Strips and Readers

Visual or automated urine analysis

- Drug Rapid Tests
- Medical Tests
- Laboratory Diagnostics
- Laboratory Service
- Consulting & Service



Reactif Urine Analysis Strips

Reactif strips

The Reactif urine analysis strips offer you quick and reliable results necessary for a targeted diagnosis. They offer not only high quality, but are also a cost-effective alternative. The reagent strips for urine analysis are firm plastic strips onto which several separate reagent areas are affixed. The tests serve to quali-

tatively and semi-quantitatively detect one or more analytes in urine. Interpretations can be made by comparing the respective analytes against the fields on the colour scale on the side of the tube containing the strips.

Available Parameters:

- ✓ Ascorbic acid
- ✓ Bilirubin
- ✓ Blood
- ✓ Calcium
- ✓ Creatinine
- ✓ Glucose
- ✓ Ketones
- ✓ Leukocytes
- ✓ Microalbumin
- ✓ Nitrite
- ✓ pH-level
- ✓ Protein
- ✓ Specific gravity
- ✓ Urobilinogen

Test procedure:

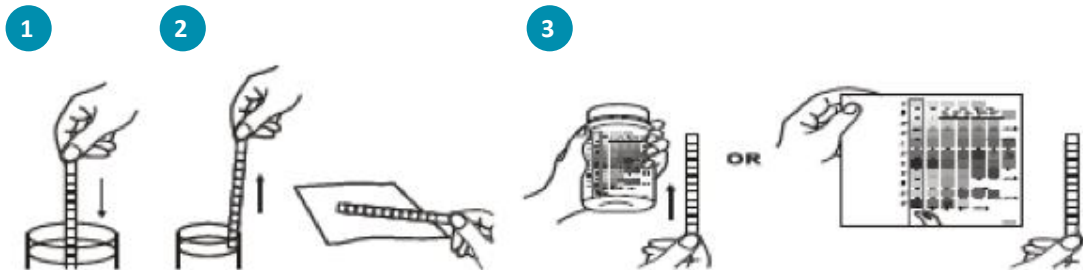

Urine Analysis

These days, urine test strips are a quick, simple and modern medical tool used to provide information on urine status and pathological changes in organisms in a short space of time. For this reason, urine test strips are an ideal aid for targeted diagnostics and play an effective part in treatments for a range of illnesses.

The test strips are designed in such a way that even slight pathological changes will be indicated by distinct colour changes in the test region. They have numerous uses, such as in routine and precautionary examinations as well during treatment and relapse management.

Controls

For all Reactif urine analysis strips, nal von minden GmbH offers a range of controls in small, practical packs. Their purpose is to verify both visually- and

machine-interpreted urine analyses. The liquid urine control is available in 2 concentrations and is ready for use in the routine monitoring of urine analyses.

Your benefits at a glance:

- ✓ Distinct colour changes in test region
- ✓ Fast and reliable test results in just 1 minute
- ✓ Test up to 14 parameters simultaneously
- ✓ Vitamin C protected
- ✓ Cost-efficient diagnoses
- ✓ Long shelf life: 12 months, 3 months once opened
- ✓ Controls available in small, inexpensive pack sizes

Product Overview Reactif Urine Analysis Strips

Product	Parameter														Tests per tube	Product code	Automated analysis	
Reactif G						G										100	41010-L	only with Reactif Touch
Reactif GP						G						P				100	41020-L	✓
Reactif 2					C				Ma							50	41021-M	✓
Reactif 2B						G	K									100	41022-L	
Reactif 3						G					pH	P				100	41030-L	✓
Reactif 3A						G	K				pH					100	41031-L	✓
Reactif 4			Bl			G					pH	P				100	41040-L	
Reactif 4A						G					pH	P	S			100	41041-L	✓
Reactif 4B						G		L		N		P				100	41042-L	✓
Reactif 5B			Bl			G	K				pH	P				100	41050-L	
Reactif 7			Bl			G	K	L		N	pH	P				100	41070-L	✓
Reactif 8		Bi	Bl			G	K			N	pH	P		U		100	41081-L	✓
Reactif 8SG			Bl			G	K	L		N	pH	P	S			100	41080-L	✓
Reactif 9		Bi	Bl			G	K			N	pH	P	S	U		100	41090-L	✓
Reactif 10SL		Bi	Bl			G	K	L		N	pH	P	S	U		100	41101-L	✓
Reactif 11M	A	Bi	Bl			G	K	L		N	pH	P	S	U	100	41110-L	✓	
															25	41110-S		
Reactif 13	A	Bi	Bl		C	G	K	L	Ma	N	pH	P	S	U	25	41130-S	✓	
Reactif 14	A	Bi	Bl	Ca	C	G	K	L	Ma	N	pH	P	S	U	50	41140-M	✓	
Reactif Level 1 & 2 Control Kit (positive and negative controls; 5 ml each)		Bi	Bl		C	G	K	L	Ma	N	pH	P	S	U	Kit	41008		

A = Ascorbic acid, Bi = Bilirubin, Bl = Blood, Ca = Calcium, C = Creatinine, G = Glucose, K = Ketone, L = Leukocytes, Ma = Microalbumin, N = Nitrite, pH = pH-level, P = Protein, S = Specific gravity, U = Urobilinogen



Reactif Touch Urine Analysis Device Series

The ideal device for every need

The Reactif Touch urine analysis devices are semi-automatic, semi-quantitative reflection photometers, which analyse and interpret the colour intensity in the reaction fields of the urine test strips. The clear touch-screen enables intuitive handling, making op-

erating the system easy to get used to within just a short space of time. The device stores the results automatically and produces a results report for tests which have been carried out. The data can then be saved easily onto a computer.

Your benefits at a glance:

- ✓ Analysis of 15 different test strips with 1-14 different parameters each
- ✓ Test Modes: routine, STAT and QC
- ✓ Large, clear touch display
- ✓ Automatic calibration
- ✓ Easy to clean
- ✓ Internal printer for up to 3 copies per test (optional: label printing for quick and easy result evaluation management)
- ✓ Operational in multiple languages
- ✓ Storage: 2000 results (automatic)
- ✓ Simple data transfer and connection to LIS or external computer
- ✓ Barcode Reader (optional)



Large, clear touch display



Removal and easy-to-clean test strip holder



Reactif Touch

Urine Analysis Device Series

Product overview

Product	Product code	Pack Size
Reactif Touch Urine Analysis Device		
Reactif Touch Urine Analysis Device	41300	1 device
Reactif Touch Urine Analysis Device incl. Barcode-Scanner	41301	1 device
Reactif Touch Barcode-Scanner	41305	1 device
Reactif Touch Data Transfer Protocol (incl. Data Transfer Cable RS 232C with Y-switch)	41306	1 piece
Accessories		
Printer paper roll	41005	4 pieces

- ✓ Output: up to 120 urine test strips per hour
- ✓ Perfectly suited to GP practices and small laboratories

Technical data

Specification	
Method	Modern imaging technology
Detection	CMOS-screen sensor
Output	Single test mode: 55 tests/hour
Measurement Cycle	Continuous Analysis: 30 seconds/test
Storage	2000 patient results 800 users
Incubation Time	1 minute
Connectivity	RS232C, 2 x USB Port, SD-Card
Resources	Internal thermal printer (inclusive) RS232C-Barcode reader (optional) USB- or RS232C-Data transfer cable (optional) Bluetooth-Adapter (not included) Ethernet via USB-to-RJ45-Adapter (not included) USB-radio network card (not included) SD card or USB flash drive to software-update (not included) Keyboard (not included) Optional external printer (not included)
Printer	Integrated or external, Parameter sequence customisable Thermal paper or adhesive labels
Data transfer	RS232C, Bluetooth, LAN, WLAN
Calibration	Automatic prior to each measurement
Locking	User lock
Barcodes	u.a. Code 39, Codabar (NW-7), Code 128, EAN13/128, Interleave 2/5
Languages	German, English, Polish
Analysis Device Operating Conditions	0 - 40 °C, <80 % relative humidity (not condensing)
Test Strip Operating Conditions	15 - 30 °C, <85 % relative humidity (not condensing)
Power Supply	6 AA alkaline batteries 100 - 240 V, 46 - 65 Hz Power saving mode
Weight	< 1.66 kg without battery or power adaptor
Measurements (Lx- WxH)	260 mm x 150 mm x 175 mm
Display	LCD-Touch-screen 116.8 mm x 88 mm (4,6" x 3,5")
Quality Assurance	Test strip batch inc. expiry date User-ID
Test Modes	Test strip batch inc. expiry date User-ID Routine analysis
Result Display	Conventional SI Arbitrary



Test strips are automatically recognised, fed into the reader and analysed.



Container for used test strips.



Reactif Touch plus

Urine Analysis Devices

Product overview

Product	Product code	Pack Size
Reactif Touch plus Urine Analysis Device		
Reactif Touch plus Urine Analysis Device	41302	1 device
Reactif Touch Urine Analysis Device incl. Barcode-Scanner	41303	1 device
Reactif Touch Barcode-Scanner	41304	1 device
Reactif Touch Data Transfer Protocol (incl. Data Transfer Cable RS 232C with Y-switch)	41307	1 piece
Accessories		
Printer paper roll	41005	4 pieces

- ✓ Output: up to 500 urine test strips per hour
- ✓ Automatic test strip recognition and alignment for higher efficiency
- ✓ Automatic transfer of strips into the device and subsequently into the waste container
- ✓ Perfect for clinics and large laboratories

Technical data

Specification	
Method	Reflection photometer
Detection	Light-sensitive diodes
Output	500 tests/hour
Measurement Cycle	7 seconds/test
Storage	2000 patient results 10 users
Incubation Time	1 minute
Connectivity	RS232C, USB-Port, Printer connection
Resources	Internal thermal printer (inclusive) External printer (not included) RS232C Barcode-Scanner (optional) RS232C Data transfer cable (optional) USB Data transfer cable (not included)
Printer	Integrated or external Parameter sequence customisable Thermal paper or adhesive labels
Data transfer	RS232C, USB
Calibration	Automatic prior to each measurement
Locking	User lock QC-lock
Barcodes	u.a. Code 39, Codabar (NW-7), Code 128, EAN13/128, Interleave 2/5
Languages	German, English Polish, French, Spanish
Analysis Device Operating Conditions	0 - 40 °C, <85 % relative humidity (not condensing)
Test Strip Operating Conditions	15 - 30 °C, <85 % relative humidity (not condensing)
Power Supply	100 - 240 V, 50 - 60 Hz
Weight	4.0 kg
Measurements (LxWxH)	36.6 cm x 28.3 cm x 19.5 cm
Display	Colour touch-screen 115 mm × 90 mm (4.5" x 3.5")
Quality Assurance	Test strip batch inc. expiry date User-ID
Test Modes	Routine analysis Emergency tes QC-Mode
Result Display	Conventional SI Arbitrary

Parameter overview

Parameter	Sensitivity (with Reactif Touch Urine Analysis Device Series)	Information (Parameter can be indicative of, for example...)
Ascorbic acid (ASC)	from 8 - 10 mg/dl (0.45 – 0.56 mmol/l)	<ul style="list-style-type: none"> ✓ High concentrations may interfere with the detection of blood and glucose
Bilirubin (BIL)	from 0.8 – 1.0 mg/dl (13.6 - 17 µmol/l)	<ul style="list-style-type: none"> ✓ Liver damage, such as cirrhosis, jaundice ✓ Close of bile ducts ✓ Severe haemolysis
Blood (BLOOD)	from 0.018 – 0.060 mg/dl or 5 - 10 Ery/µl with an ascorbic acid content from <50 mg/dl	<ul style="list-style-type: none"> ✓ Haematuria, e.g. as a result of renal or urogenital tract diseases ✓ Tumours (eg. kidney or bladder tumours) ✓ Kidney or bladder damage, as well as kidney stones ✓ Prostate disease
Calcium (CA)	between 4 mg/dl (1.0 mmol/l) and 40 mg/dl (10 mmol/l)	<ul style="list-style-type: none"> ✓ For the balancing of calcium in the body, e.g. in osteoporosis ✓ Tumours with bone metastases ✓ Certain forms of kidney damage
Creatinine (CRE)	between 10 - 300 mg/dl (0.9 mmol/l – 26.5 mmol/l)	<ul style="list-style-type: none"> ✓ Acute or chronic renal failure ✓ Diabetic kidney disease
Glucose (GLU)	from 80 - 100 mg/dl (4 - 5 mmol/l)	<ul style="list-style-type: none"> ✓ Diabetes screening and management ✓ Detection of certain forms of kidney damage ✓ Monitoring of pregnancy
Ketone (KET)	from 4 - 5 mg/dl (0.4 – 0.5 mmol/l)	<ul style="list-style-type: none"> ✓ Alcohol misuse (ketoacidosis) ✓ Diabetes mellitus Type 1 (ketoacidosis) ✓ Starving periods ✓ Lactate acidosis
Leukocytes (LEU)	From at least 12 - 15 white blood cells (Leu/µl) in clinical urine	<ul style="list-style-type: none"> ✓ Urinary tract infection (common cause: bladder infection) ✓ Mild leukocyturia (seemingly abacterial): e.g. tuberculosis bacteria, chlamydia or similar infection; or autoimmune disease, tumours of the urinary tract
Microalbumin (ALB)	from 20 - 30 mg/l	<ul style="list-style-type: none"> ✓ Early detection of renal function impairment
Nitrite (NIT)	from 0.05 mg/dl in urine with a low specific weight and less than 30 mg/dl ascorbic acid	<ul style="list-style-type: none"> ✓ Bacterial urinary tract infection ✓ A negative reading does not preclude the possibility of an urinary tract infection!
pH-level (pH)	Quantitative between pH 5 and 9	<ul style="list-style-type: none"> ✓ Strongly dependant on diet (vegetarian → more alkaline, carnivorous → more acidic) ✓ Orientation of acid-base-homeostasis ✓ Higher pH-level (alkaline urine): Potential urinary tract infection ✓ Lower pH-level (acidic urine): Diabetes, urinary stones

Protein (PRO)	from 12 - 15 mg/dl (0.125 – 0.150 g/l)	<ul style="list-style-type: none"> ✓ Stronger, non-transient proteinuria: kidney disease (inspecific) ✓ Further differential diagnosis required
Specific gravity (SG)	between 1.000 und 1.030	<ul style="list-style-type: none"> ✓ Thinning or concentration of urine (depending on drinks consumed and fluid loss (sweating)) ✓ Permanently low density: kidney disease, insensitivity to ADH hormone (diabetes insipidus) ✓ Influence on other test strip parameters: Confirm or invalidation of the pathological relevance of borderline results
Urobilinogen (URO)	ab 0.8 - 1.0 mg/dl (13.6 - 17 µmol/l)	<ul style="list-style-type: none"> ✓ Acute and chronic liver disease (e.g. viral hepatitis, liver cirrhosis) and restricted liver function ✓ Toxic liver damage ✓ Haemolytic illness

* Information is without guarantee and intended as example; increases or decreases in values can have various causes which must be clarified by differential diagnoses.



Deutschland (Headquarters)

Carl-Zeiss-Strasse 12, 47445 Moers
Tel.:+49 2841 99 820-0
Fax:+49 2841 99 820-1

Friedenstrasse 32, 93053 Regensburg
Tel.:+49 941 290 10-0
Fax:+49 941 290 10-50

info@nal-vonminden.de
www.nal-vonminden.de



Belgique / België

Français:

Numéro gratuit:0800 718 82
Fax gratuit:0800 747 07
dept.ventes@nal-vonminden.com

www.nal-vonminden.fr

Nederlands:

Gratis Tel:0800 780 85
Fax:+31 70 3030 775
verkoop.dept@nal-vonminden.nl

www.nal-vonminden.nl



Česká republika

Bezplatný tel.:800 143 685
Bezplatný fax:800 143 686
czech@nal-vonminden.com

www.nal-vonminden.cz

Danmark

Gratis nummer:80888753
Fax:+31 7030 30775
distribution@nal-vonminden.dk

www.nal-vonminden.dk

Deutschland

Gratis-Tel.:0800 589 2022
Gratis-Fax:0800 589 2023
vertrieb.abt@nal-vonminden.de

www.nal-vonminden.de

España

Tel. gratuito:900 938 315
Fax gratuito:900 984 992
Tel. directo:+49 941 290 10-761
Fax directo:+49 941 290 10-50

ventas@nal-vonminden.es
www.nal-vonminden.es



France

Numéro vert:0800 915 240
Fax gratuit:0800 909 493
N° international: ..+49 941 290 10-739
Fax international: ...+49 941 290 10-50
dept.ventes@nal-vonminden.fr

www.nal-vonminden.fr

Ireland

Free phone:1800 555 008
Free fax:1800 555 080
sales-dept@nal-vonminden.com

www.nal-vonminden.com

Italia

Numero verde:800 789 129
Fax gratuito:800 789 130
vendite.dipt@nal-vonminden.it

www.nal-vonminden.it

Luxembourg

Numéro gratuit:800 211 16
Fax gratuit:800 261 79
dept.ventes@nal-vonminden.fr

www.nal-vonminden.fr

Nederland

Gratis Tel:0800 022 2890
Gratis Fax:0800 024 95 19
verkoop.dept@nal-vonminden.nl

www.nal-vonminden.nl

Norge

Free phone:800 16 731
fax:+31 703 030 775
norway@nal-vonminden.com

www.nal-vonminden.com

Österreich

Gratis Tel:0800 291 565
Gratis Fax:0800 298 197
vertrieb.abt@nal-vonminden.de

www.nal-vonminden.de

Polska

Bezpłatny tel.:00800 4911595
Bezpłatny fax:00800 4911594
sprzedaz.dept@nal-vonminden.pl

www.nal-vonminden.pl

Portugal

Tel. gratuito:800 849 230
Fax gratuito:800 849 229
Tel. direto:+49 941 290 10-735
Fax direto:+49 941 290 10-50

vendas@nal-vonminden.pt
www.nal-vonminden.pt

Schweiz / Suisse / Svizzera

Deutsch:

Gratis-Tel.:0800 832 164
Gratis-Fax:0800 837 476
info@nal-vonminden.de

www.nal-vonminden.de

Français:

Numéro gratuit:0800 564 720
Fax gratuit:0800 837 476
dept.ventes@nal-vonminden.fr

www.nal-vonminden.fr

Italiano:

Numero verde:0800 832 2146
Fax gratuito:0800 837 476
vendite.dipt@nal-vonminden.it

www.nal-vonminden.it

Suomi

Ilmainen Puh:0800 918263
Ilmainen Fax:0800 918262
myynti.dept@nal-vonminden.com

www.nal-vonminden.com/fi

Sverige

Gratis Tel.:020 790906
Gratis Fax:020 798292
sweden@nal-vonminden.com

www.nal-vonminden.se

United Kingdom

Free phone:0808 234 1237
Free fax:0808 234 1618
sales-dept@nal-vonminden.com

www.nal-vonminden.com