



NADAL[®] FOB/Transferrin Test

Rapid test for the qualitative detection and differentiation of human haemoglobin and transferrin in stool samples

Gastrointestinal diseases

Bowel cancer can develop in the colon as well as in the rectum. The third most common cancer, it affects both men and women equally, with those over 50 being at a much higher risk. For this reason, regular check ups and bowel cancer screenings are strongly recommended.

Invisible blood - known as 'occult blood' - is an important primary indicator in the assessment of patients with suspected bowel cancer. Haemoglobin - as a component of blood - is an analyte examined in cases of potential bowel cancer. The simultaneous testing for transferrin, which transports iron in the blood, increases the test's sensitivity, as it is more stable against acids and protein degradation in the digestive tract. For this reason - and in contrast to haemoglobin - transferrin is still detectable once released into the upper gastrointestinal tract.

The presence of blood in stool samples can also have other causes, including haemorrhoids, bowel polyps, peptic ulcer disease or gastric irritation. In the case of a positive result when screening for occult blood in stool samples, it is necessary to then carry out further tests.

NADAL[®] FOB/Transferrin Test

The NADAL[®] FOB/Transferrin test is a chromatographic immunoassay in a lateral flow format. It is intended for use in the qualitative detection of human haemoglobin and transferrin and can be interpreted visually. The test is a useful aid in the diagnosis of gastrointestinal illnesses associated with gastrointestinal bleeding, and is intended for professional *in-vitro* diagnostic use.

The combined detection of haemoglobin and transferrin in stool samples offers an alternative means of diagnosing illnesses throughout the digestive tract.

Your benefits at a glance:

- ✓ Two parameters in one test
- ✓ Early detection of illnesses throughout the gastrointestinal tract
- ✓ Sampling can take place at home
- ✓ No specialised diet required
- ✓ Storage at room temperature
- ✓ Fast, reliable results in just 5 minutes



Test procedure

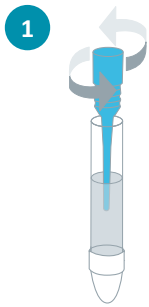

1 Remove the sample collector from the tube.

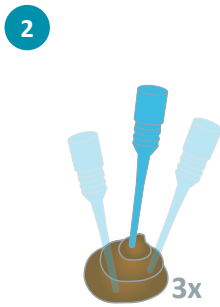

2 Dip it in at least 3 different sites of the stool sample.

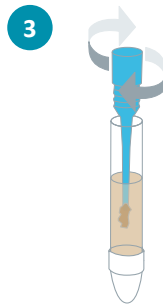

3 Put the sample collector, along with the collected faeces, back into the sample tube and tightly screw the lid closed.

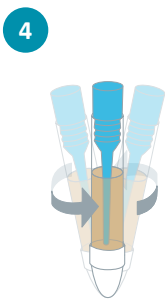

4 Shake the tube vigorously.



5 Unscrew the protective cap and remove the seal from the tube by turning it.

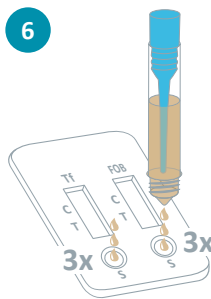

6 Holding the tube vertically, discard the first 2 drops of the sample solution. Then dispense 3 drops into the sample well (S) of the test cassette.



7 Read the results after 5 minutes.

For detailed instructions, please see the package insert.

Result interpretation

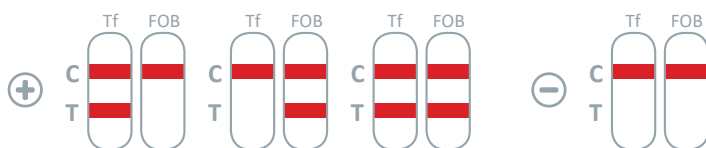

NADAL® FOB/Transferrin Test

Rapid test for the detection and differentiation of human haemoglobin and transferrin

Product	Sample material	Sensitivity	Specificity	Product code	Pack size
NADAL® FOB/ Transferrin Test	Stool	Tf: 98.5 % Hb: 97.8 %	Tf: 99.4 % Hb: 98.7 %	272038	20 tests

Pack contains: Test cassettes • Sample collection tube with buffer • Package insert

Our **customer service team** is on hand to answer any questions you may have by telephone, via email or in a personal consultation. For details on **your local sales office and regional free phone numbers**, visit www.nal-vonminden.com.

We help you care!

Rapid Tests

Laboratory Diagnostics

Laboratory Service

Consulting & Service